



8 1 4 0 9 4 4
Tx:8107822

2016OR020739

**COLLEEN M. SWEDYK
MEDINA COUNTY RECORDER
MEDINA, OH
RECORDED ON
09/16/2016 1:10 PM**

**REC FEE: 168.00
PAGES: 20
DOC TYPE: AMEND/DECLAR**

MEDINA COUNTY RECORDER

COLLEEN M. SWEDYK

**(DO NOT REMOVE THIS COVER SHEET.
THIS IS THE FIRST PAGE OF THIS DOCUMENT)**

**AMENDMENT TO MASTER DECLARATION
OF COVENANTS, CONDITIONS, EASEMENTS AND RESTRICTIONS
OF FOX MEADOW**

THIS AMENDMENT TO MASTER DECLARATION OF COVENANTS, CONDITIONS, EASEMENTS AND RESTRICTIONS OF FOX MEADOW (“Amendment”) is made as of the ~~30th~~^{30th} day of ~~September~~^{August}, 2016, pursuant to the terms and conditions contained herein. Terms used herein shall have the same meanings ascribed to them as those defined in the Master Declaration of Covenants, Conditions, Easements and Restrictions of Fox Meadow as recorded in Vol. OR1002, Page 794-874 of the Official Records of Medina County, Ohio, as amended to date (the “Declaration”).

Whereas, On January 11, 1995, Fox Meadow Development Limited Partnership, an Ohio limited partnership, as “Declarant” under the Declaration, recorded the Declaration against that certain property located in the Township of Montville, County of Medina and State of Ohio, as more particularly described in the Declaration, known as the Fox Meadow Subdivision.

Whereas, The Declaration was amended on April 1, 1997 by instrument recorded in Vol. 1277, Page 639, on June 26, 1998 by instrument recorded as instrument no. 1998OR003970, on June 25, 1999 by instrument recorded as instrument no. 1999OR022105, on January 26, 2006 by instrument recorded as instrument no. 2006OR002551, and on January 30, 2006 by instrument recorded as instrument no. 2006OR002932 of the Medina County Records; and

Whereas, Evergreen Land Development, Ltd., an Ohio limited liability company, is the successor Declarant under the Declaration pursuant to that certain Assignment and Assumption of Declarant Rights recorded August 6, 2004 as Instrument No. 2004OR032108 of the Medina County Records (“Successor Declarant”) (for purposes of the Declaration, Successor Declarant should be one and the same as Declarant), and

Whereas, pursuant to Article XV, Section 15.12, the Declaration may be amended or modified by a recorded instrument executed by the Declarant for so long as the Declarant or Successor Declarant is the owner of a fee simple interest in the Property all in accordance with the provisions of Section 15.12 of the Declaration, and

Whereas, The Successor Declarant is the owner of Vacant Sublot No 219, parcel no. 030-11A-22-130; and

Whereas, Pursuant to Section 15.12 of the Declaration, the Successor Declarant is signing as attorney-in-fact on behalf of all Owners, and the Successor Declarant requests that the Fox Meadow Master Association, Inc., an Ohio non-profit corporation (“Master Association”) join in the execution of this Amendment acknowledging and accepting the modification to the Declaration set forth herein; and

Whereas, the proceedings necessary to modify the Declaration as required by Article XV of the Declaration have in all respects been complied with or waived.

NOW, THEREFORE, pursuant to Article XV, Section 15.12, the Declaration is hereby amended and modified as follows:

1. The Design Review Committee Policies and Guidelines as described in Article VIII, Section 8.2(c) are hereby modified to permit that exterior basement walls may be either (i) a minimum of 12” block; or (ii) poured foundations. The exposed portions of all exterior foundations shall be brick or stone.
2. Article VII, Section 7.6 is hereby deleted in its entirety and the following is substituted therein.

“Section 7.6 – Signs

No sign or other advertising device of any nature shall be placed upon any portion of the Property except for signs and advertising devices installed by or at the direction of the Design Review Committee, or which the Design Review Committee approves as to color, location, nature, size and similar characteristics. All signs shall comply with the Township’s requirements. “For Rent” signs are prohibited. “For Sale” signs are permitted with the prior written approval of the Design Review Committee as to type, size and location of such signs. Security system signs no larger than one (1) foot by one (1) foot are permitted. Notwithstanding the foregoing, temporary signs for charity events, Master Association social events, Master Association informational notices, student resident signs and real estate open house signs (provided all real estate open house signs are only permitted Friday through Sunday) are permitted; provided, the same are subject to the written guidelines established by the Design Review Committee from time to time. Notwithstanding the foregoing, the above restrictions shall not apply to the Declarant or to a Builder or real estate company authorized by the Declarant.”

3. Article VII, Section 7.13 is hereby deleted in its entirety and the following is substituted therein.

“Section 7.13 – Poles, Wires, Antenna and Satellite Dishes

Subject to applicable easement rights, no facilities, including poles and wires, for the transmission or receipt of electricity, telephone messages, ham radio messages and the like shall be placed or maintained above the surface of the ground on any portion of the Property without the prior approval of the Design Review Committee and subject to local governmental rules and regulations. This provision shall not apply for temporary facilities for the construction or repair of any building or other structure. A Digital or Direct Satellite System (“DDS System”), thirty-nine inches (39”) or less in diameter, may be attached to a Living Unit; provided, that if the DDS System is placed at the front of a Dwelling Unit the DDS System must be placed on the roof and the prior approval of the location of the DDS System must first be obtained from the Design Review Committee and the same must comply with local governmental rules and regulations.”

4. Article VII is hereby amended by adding the following new Section 7.26.

“Section 7.26 – Sexual Predators/Habitual Sex Offenders

No person who is adjudicated or designated to be a sexual predator or a habitual sex offender by an appropriate court or law enforcement agency and required to register with a designated registering agency, or any similar laws of the State of Ohio, thereby requiring notice to be given pursuant to the Ohio Sex Offenders Act or similar statute from another jurisdiction, as the same may from time to time be amended, may reside in or occupy a Living Unit for any length of time, nor enter upon the Property as a guest, visitor, employee or contractor of a Living Unit or Occupant of a Living Unit. The Master Association may enforce the provisions of this Section by commencing an action to enjoin such person from occupying a Living Unit and/or from coming on the Property and to evict such person, and any violation of this restriction shall subject the Owner and/or any Occupant of the Living Unit to any and all remedies provided for by law as well as this Declaration, including charging the Owner with all costs in connection therewith, including attorneys’ fees and paralegal fees. The Master Association shall not, however, be liable to any Owner or Occupant, or anyone visiting any Owner or the Maser Association, as a result of the Master Association’s alleged failure, whether negligent, intentional or otherwise, to enforce the provisions of this restriction. Any conflict between this Section and any other provision of the Declaration shall be interpreted in favor of this Section on the occupancy of the Living Unit.”

5. Article VII is hereby amended by adding the following new Section 7.27.

“Section 7.27 – Unmanned Aircraft Systems

All unmanned aircraft systems (UAS), including, without limitation, any aerial remote controlled devices (e.g. drones, model planes, model helicopters), are prohibited to be flown on the Property for recreational purposes. No UAS shall be flown for commercial purposes without first obtaining the prior consent of the Master Board. The Master Board may impose reasonable rules and restrictions as to the use of commercial UAS’s on the Property from time to time. If the foregoing restrictions violate any state or federal rule, law or order, including any Federal Aviation Administration rule (collectively, “Rules”), the foregoing shall be modified to comply with said Rules; provided the most restrictive legal interpretation shall become the new standard by which the UAS’s may be used on the Property.”

6. Article VII is hereby amended by adding the following new Section 7.28.

“Section 7.28 – Playhouses and other Structures.

Accessory structure such as playhouses, play sets, tool sheds, doghouses or dog-runs shall not be permitted unless the written approval of the Design Review Committee is first obtained. The Design Review Committee shall have the right to grant variances to the below restrictions in its sole discretion due to irregular Living Unit Lot configurations. Trampolines, plastic houses and plastic or metal play sets are prohibited. All permitted play sets shall be subject to the following restrictions:

(i) The leading edge of any play set shall be a minimum of twenty-five feet (25’) from all property lines of a Living Unit Lot.

(ii) Every play set plan must include landscaping on at least two (2) sides of the play set to screen the view of the play set from neighbors and the Golf Course.

(iii) All play sets on Living Unit Lots adjacent to the Golf Course must be located and screened in a manner to limit the disturbance of the golfer and to protect children from errant golf balls.

(iv) All play sets must be located on grass or mulched areas.

(v) All play sets shall be made of natural wood and any canopies must be made of natural material and the color must blend in with the surrounding environment.

(vi) No play set shall be placed in the front or side of the Living Unit Lot.

(vii) All play sets shall be maintained in good condition.”

7. Article VII is hereby amended by adding the following new Section 7.29.

“Section 7.29 – Soccer Nets.

Soccer nets shall not be permitted unless the written approval of the Design Review Committee is first obtained. All soccer nets shall not be closer than twenty feet (20') from the Golf Course or other Common Areas. All soccer nets must be temporary and moveable.”

8. Article VII is hereby amended by adding the following new Section 7.30.

“Section 7.30 – Mail Boxes.

All mailboxes shall be made of wood constructed around a metal U.S. mailbox, and shall be mounted on a 6”x 6” treated wood post extending 80” above grade. The front face of the mailbox shall be located 6” to 8” from the street curbing. Each mailbox shall have numbers 5” in height that are to be placed on the upper end of the mailbox post on both sides of the so as to be visible to passing traffic. The wooden mailbox (with newspaper box) shall be mounted 32.5” to 37” above grade. The mailbox shall be 16” to 18” high, 9 ¾” wide and 21” in length. The newspaper box shall be 7” wide and 8” high and 21” in length attached to the post. If an Owner desires to stain the post and mailbox, the color of the stain shall be compatible with the color of the Living Unit; provided, that the Design Review Committee reserves the right to require the Owner of the Living Unit to re-stain the post and mail box if the Design Review Committee determines that the stain color is not compatible with the color of the Living Unit.”

9. Article II, Section 3 of the Code of Regulations of Fox Meadow Master Association, Inc. is hereby deleted in its entirety and replaced with the following:

“Section 3. Annual Meeting.

The Master Board shall schedule the annual meeting of the Master Association at any time during the last quarter of a calendar year. Subject to the foregoing, the annual meeting of the Members shall be held at a date and time as set by the Master Board.”

10. The Declaration as herein amended and supplemented remains in full force and effect and is reaffirmed and binding on the Property.

[Signature Pages Follow]

IN WITNESS WHEREOF, the Successor Declarant and the President and Secretary of the Association have caused this Amendment to be signed on the date set forth below.

**SUCCESSOR DECLARANT:
EVERGREEN LAND DEVELOPMENT LTD.**

By: 
Name: Daniel B. Aufer
Title: Manager

STATE OF OHIO)
) ss:
COUNTY OF MEDINA)

BEFORE ME, a Notary Public in and for said county and state, personally appeared Daniel B. Aufer, Manager of Evergreen Land Development, Ltd., an Ohio limited liability company, who acknowledged that he did execute the foregoing instrument on behalf of said limited liability company and that the same is his free act and deed.

IN WITNESS WHEREOF, I have hereunto set my hand this 31st day of August, 2016.

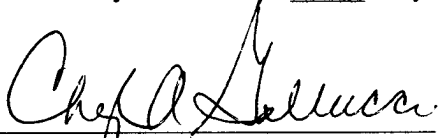

CHERYL A. GALLUCCI
Notary Public
NOTARY PUBLIC
STATE OF OHIO
Comm. Expires
August 01, 2021



FOX MEADOW MASTER ASSOCIATION, INC.

By: Theodore R. Lesiak
Name: Theodore R. Lesiak
Title: President

By: Sharon Borszcz
Name: Sharon Borszcz
Title: Secretary

STATE OF OHIO)
) SS:
COUNTY OF MEDINA)

BEFORE ME, a Notary Public, in and for said county and state, personally appeared the above named Theodore R. Lesiak, as the President of **FOX MEADOW MASTER ASSOCIATION, INC.**, who acknowledged that he did execute the foregoing instrument and that the same is his free act and deed and the free act and deed of said corporation.

IN WITNESS WHEREOF, I have hereunto set my hand this 30 day of August, 2016.

Heather Ward
NOTARY PUBLIC

STATE OF OHIO)
) SS:
COUNTY OF MEDINA)

 **HEATHER J WARD**
Notary Public State of Ohio
My Comm. Expires September 21, 2019

BEFORE ME, a Notary Public, in and for said county and state, personally appeared the above named Sharon Borszcz, as the Secretary of **FOX MEADOW MASTER ASSOCIATION, INC.**, who acknowledged that she did execute the foregoing instrument and that the same is her free act and deed and the free act and deed of said corporation.

IN WITNESS WHEREOF, I have hereunto set my hand this 30 day of August, 2016.

Heather Ward
NOTARY PUBLIC

Instrument Prepared By:
John M. Coyne, III, Esq.
Roetzel & Andress
222 South Main Street
Akron, Ohio 44308
330-376-2700

 **HEATHER J WARD**
Notary Public State of Ohio
My Comm. Expires September 21, 2019

Located in Montville Township, Medina County, State of Ohio

		Lot #					Parcel
Montville Lot 42	Sub lot	1	Fox Meadow	PH 1			Parcel Number 30-11A-17-002
Montville Lot 42	Sub lot	2	Fox Meadow	PH 1			Parcel Number 30-11A-18-006
Montville Lot 42	Sub lot	3	Fox Meadow	PH 1			Parcel Number 30-11A-18-007
Montville Lot 42	Sub lot	4	Fox Meadow	PH 1			Parcel Number 30-11A-18-008
Montville Lot 42	Sub lot	5	Fox Meadow	PH 1			Parcel Number 30-11A-18-009
Montville Lot 42	Sub lot	6	Fox Meadow	PH 1			Parcel Number 30-11A-18-010
Montville Lots 42, 51	Sub lot	7	Fox Meadow	PH 1			Parcel Number 30-11A-18-011
Montville Lot 51	Sub lot	8	Fox Meadow	PH 1			Parcel Number 30-11A-18-012
Montville Lot 51	Sub lot	9	Fox Meadow	PH 1			Parcel Number 30-11A-18-013
Montville Lot 51	Sub lot	10	Fox Meadow	PH 1			Parcel Number 30-11A-18-014
Montville Lot 51	Sub lot	11	Fox Meadow	PH 1			Parcel Number 30-11A-18-015
Montville Lot 51	Sub lot	12	Fox Meadow	PH 1			Parcel Number 30-11A-18-016
Montville Lot 51	Sub lot	13	Fox Meadow	PH 1			Parcel Number 30-11A-18-017
Montville Lot 51	Sub lot	14	Fox Meadow	PH 1			Parcel Number 30-11A-18-018
Montville Lot 51	Sub lot	15	Fox Meadow	PH 1			Parcel Number 30-11A-18-019
Montville Lot 51	Sub lot	16	Fox Meadow	PH 1			Parcel Number 30-11A-18-020
Montville Lot 51	Sub lot	17	Fox Meadow	PH 1			Parcel Number 30-11A-18-021
Montville Lot 51	Sub lot	18	Fox Meadow	PH 1			Parcel Number 30-11A-18-022
Montville Lot 51	Sub lot	19	Fox Meadow	PH 1			Parcel Number 30-11A-18-023
Montville Lot 51	Sub lot	20	Fox Meadow	PH 1			Parcel Number 30-11A-18-024
Montville Lot 51	Sub lot	21	Fox Meadow	PH 1			Parcel Number 30-11A-18-025
Montville Lots 51, 52	Sub lot	22	Fox Meadow	PH 1			Parcel Number 30-11A-18-026
Montville Lots 51, 52	Sub lot	23	Fox Meadow	PH 1			Parcel Number 30-11A-18-027
Montville Lot 52	Sub lot	24	Fox Meadow	PH 1			Parcel Number 30-11A-18-028
Montville Lot 52	Sub lot	25	Fox Meadow	PH 1			Parcel Number 30-11A-18-029
Montville Lot 52	Sub lot	26	Fox Meadow	PH 1			Parcel Number 30-11A-18-030
Montville Lot 52	Sub lot	27	Fox Meadow	PH 1			Parcel Number 30-11A-22-001
Montville Lot 52	Sub lot	28A	Fox Meadow	PH 1		Replat # 2(FKA SL-28)	Parcel Number 30-11A-22-002
Montville Lot 52	Sub lot	29	Fox Meadow	PH 1			Parcel Number 30-11A-22-003
Montville Lot 52	Sub lot	30	Fox Meadow	PH 1			Parcel Number 30-11A-22-004
Montville Lot 52	Sub lot	31	Fox Meadow	PH 1			Parcel Number 30-11A-22-005
Montville Lot 52	Sub lot	32	Fox Meadow	PH 1			Parcel Number 30-11A-22-006
Montville Lot 52	Sub lot	33	Fox Meadow	PH 1			Parcel Number 30-11A-22-007
Montville Lot 52	Sub lot	34	Fox Meadow	PH 1			Parcel Number 30-11A-18-031
Montville Lot 52	Sub lot	35	Fox Meadow	PH 1			Parcel Number 30-11A-18-032
Montville Lot 52	Sub lot	36	Fox Meadow	PH 1			Parcel Number 30-11A-18-033
Montville Lot 52	Sub lot	37	Fox Meadow	PH 1			Parcel Number 30-11A-18-034
Montville Lot 52	Sub lot	38	Fox Meadow	PH 1			Parcel Number 30-11A-18-035
Montville Lot 52	Sub lot	39	Fox Meadow	PH 1			Parcel Number 30-11A-18-036
Montville Lot 52	Sub lot	40	Fox Meadow	PH 1			Parcel Number 30-11A-18-037
Montville Lot 52	Sub lot	41	Fox Meadow	PH 1			Parcel Number 30-11A-18-038
Montville Lots 51, 52	Sub lot	42	Fox Meadow	PH 1			Parcel Number 30-11A-18-039

~~256253~~

Located in Montville Township, Medina County, State of Ohio

Montville Lot 51,52	Sub lot	43	Fox Meadow	PH 1		Parcel Number	30-11A-18-040
Montville Lot 51,52	Sub lot	44	Fox Meadow	PH 1		Parcel Number	30-11A-18-041
Montville Lot 51,52	Sub lot	45	Fox Meadow	PH 1		Parcel Number	30-11A-18-042
Montville Lot 51,52	Sub lot	46	Fox Meadow	PH 1		Parcel Number	30-11A-18-043
Montville Lot 51	Sub lot	47	Fox Meadow	PH 1		Parcel Number	30-11A-18-044
Montville Lot 51	Sub lot	48	Fox Meadow	PH 1		Parcel Number	30-11A-18-045
Montville Lot 42,51	Sub lot	49	Fox Meadow	PH 1		Parcel Number	30-11A-18-046
Montville Lot 42,51	Sub lot	50	Fox Meadow	PH 1		Parcel Number	30-11A-18-047
Montville Lot 42	Sub lot	51	Fox Meadow	PH 1		Parcel Number	30-11A-18-048
Montville Lot 42	Sub lot	52	Fox Meadow	PH 1		Parcel Number	30-11A-18-049
Montville Lot 42	Sub lot	53	Fox Meadow	PH 1		Parcel Number	30-11A-18-050
Montville Lot 42	Sub lot	54	Fox Meadow	PH 1		Parcel Number	30-11A-18-051
Montville Lot 42	Sub lot	55	Fox Meadow	PH 1		Parcel Number	30-11A-18-052
Montville Lot 42	Sub lot	56	Fox Meadow	PH 1		Parcel Number	30-11A-18-053
Montville Lot 42	Sub lot	57	Fox Meadow	PH 1		Parcel Number	30-11A-18-054
Montville Lot 42	Sub lot	58	Fox Meadow	PH 1		Parcel Number	30-11A-18-055
Montville Lot 42	Sub lot	59	Fox Meadow	PH 1		Parcel Number	30-11A-18-056
Montville Lot 42,51	Sub lot	60	Fox Meadow	PH 1		Parcel Number	30-11A-18-057
Montville Lot 51	Sub lot	61	Fox Meadow	PH 1		Parcel Number	30-11A-18-058
Montville Lot 51	Sub lot	62	Fox Meadow	PH 1		Parcel Number	30-11A-18-059
Montville Lot 51	Sub lot	63	Fox Meadow	PH 1		Parcel Number	30-11A-18-060
Montville Lot 51	Sub lot	64	Fox Meadow	PH 1		Parcel Number	30-11A-18-061
Montville Lot 51	Sub lot	65	Fox Meadow	PH 1		Parcel Number	30-11A-18-062
Montville Lot 51	Sub lot	66	Fox Meadow	PH 1		Parcel Number	30-11A-18-063
Montville Lot 51	Sub lot	67	Fox Meadow	PH 1		Parcel Number	30-11A-18-064
Montville Lot 51	Sub lot	68	Fox Meadow	PH 1		Parcel Number	30-11A-18-065
Montville Lot 51	Sub lot	69	Fox Meadow	PH 1		Parcel Number	30-11A-18-066
Montville Lot 51	Sub lot	70	Fox Meadow	PH 1		Parcel Number	30-11A-18-067
Montville Lot 51,52	Sub lot	71	Fox Meadow	PH 1		Parcel Number	30-11A-18-068
Montville Lot 51,52	Sub lot	72	Fox Meadow	PH 1		Parcel Number	30-11A-18-069
Montville Lot 51	Sub lot	73	Fox Meadow	PH 1		Parcel Number	30-11A-18-070
Montville Lot 51	Sub lot	74	Fox Meadow	PH 1		Parcel Number	30-11A-18-071
Montville Lot 51	Sub lot	75	Fox Meadow	PH 1		Parcel Number	30-11A-18-072
Montville Lot 51	Sub lot	76	Fox Meadow	PH 1		Parcel Number	30-11A-18-073
Montville Lot 51	Sub lot	77	Fox Meadow	PH 1		Parcel Number	30-11A-18-074
Montville Lot 51	Sub lot	78	Fox Meadow	PH 1		Parcel Number	30-11A-18-075
Montville Lot 51	Sub lot	79	Fox Meadow	PH 1		Parcel Number	30-11A-18-076
Montville Lot 51	Sub lot	80	Fox Meadow	PH 1		Parcel Number	30-11A-18-077
Montville Lot 51	Sub lot	81	Fox Meadow	PH 1		Parcel Number	30-11A-18-078
Montville Lot 51	Sub lot	82	Fox Meadow	PH 1		Parcel Number	30-11A-18-079
Montville Lot 51	Sub lot	83	Fox Meadow	PH 1		Parcel Number	30-11A-18-080
Montville Lot 51	Sub lot	84	Fox Meadow	PH 1		Parcel Number	30-11A-18-081
Montville Lot 42,51	Sub lot	85	Fox Meadow	PH 1		Parcel Number	30-11A-18-082
Montville Lot 42	Sub lot	86	Fox Meadow	PH 1		Parcel Number	30-11A-18-083

256254

Located in Montville Township, Medina County, State of Ohio

Montville Lot 42	Sub lot	87	Fox Meadow	PH 1	Parcel Number	30-11A-18-084
Montville Lot 42	Sub lot	88	Fox Meadow	PH 2	Parcel Number	30-11A-17-011
Montville Lot 42	Sub lot	89	Fox Meadow	PH 2	Parcel Number	30-11A-17-012
Montville Lot 42	Sub lot	90	Fox Meadow	PH 2	Parcel Number	30-11A-17-013
Montville Lot 42	Sub lot	91	Fox Meadow	PH 2	Parcel Number	30-11A-17-014
Montville Lot 42	Sub lot	92	Fox Meadow	PH 2	Parcel Number	30-11A-17-015
Montville Lot 42	Sub lot	93	Fox Meadow	PH 2	Parcel Number	30-11A-17-016
Montville Lot 42	Sub lot	94	Fox Meadow	PH 2	Parcel Number	30-11A-17-017
Montville Lot 42	Sub lot	95	Fox Meadow	PH 2	Parcel Number	30-11A-17-018
Montville Lot 42	Sub lot	96	Fox Meadow	PH 2	Parcel Number	30-11A-17-019
Montville Lot 42	Sub lot	97	Fox Meadow	PH 2	Parcel Number	30-11A-17-020
Montville Lot 42	Sub lot	98	Fox Meadow	PH 2	Parcel Number	30-11A-12-081
Montville Lot 42	Sub lot	99	Fox Meadow	PH 2	Parcel Number	30-11A-12-082
Montville Lot 42	Sub lot	98	Fox Meadow	PH 2	Parcel Number	30-11A-12-082
Montville Lot 42	Sub lot	99	Fox Meadow	PH 2	Parcel Number	30-11A-12-083
Montville Lot 42	Sub lot	100	Fox Meadow	PH 2	Parcel Number	30-11A-12-084
Montville Lot 42	Sub lot	101	Fox Meadow	PH 2	Parcel Number	30-11A-12-085
Montville Lot 42	Sub lot	102	Fox Meadow	PH 2	Parcel Number	30-11A-12-086
Montville Lot 42	Sub lot	103	Fox Meadow	PH 2	Parcel Number	30-11A-12-087
Montville Lot 42	Sub lot	104	Fox Meadow	PH 2	Parcel Number	30-11A-12-088
Montville Lot 42	Sub lot	105	Fox Meadow	PH 2	Parcel Number	30-11A-12-089
Montville Lot 42	Sub lot	106	Fox Meadow	PH 2	Parcel Number	30-11A-12-090
Montville Lot 42	Sub lot	107	Fox Meadow	PH 2	Parcel Number	30-11A-12-091
Montville Lot 42	Sub lot	108	Fox Meadow	PH 2	Parcel Number	30-11A-12-092
Montville Lot 42	Sub lot	109	Fox Meadow	PH 2	Parcel Number	30-11A-12-093
Montville Lot 42	Sub lot	110	Fox Meadow	PH 2	Parcel Number	30-11A-12-094
Montville Lot 42	Sub lot	111	Fox Meadow	PH 2	Parcel Number	30-11A-12-095
Montville Lot 42	Sub lot	112	Fox Meadow	PH 2	Parcel Number	30-11A-12-096
Montville Lot 42	Sub lot	113	Fox Meadow	PH 2	Parcel Number	30-11A-12-097
Montville Lot 42	Sub lot	114	Fox Meadow	PH 2	Parcel Number	30-11A-12-098
Montville Lot 42	Sub lot	115	Fox Meadow	PH 2	Parcel Number	30-11A-12-099
Montville Lot 42	Sub lot	116	Fox Meadow	PH 2	Parcel Number	30-11A-12-100
Montville Lot 42	Sub lot	117	Fox Meadow	PH 2	Parcel Number	30-11A-12-101
Montville Lots 31, 42	Sub lot	118	Fox Meadow	PH 2	Parcel Number	30-11A-12-102
Montville Lots 31, 42	Sub lot	119	Fox Meadow	PH 2	Parcel Number	30-11A-17-021
Montville Lot 31	Sub lot	120	Fox Meadow	PH 2	Parcel Number	30-11A-17-022
Montville Lot 31	Sub lot	121	Fox Meadow	PH 2	Parcel Number	30-11A-17-023
Montville Lot 31	Sub lot	122	Fox Meadow	PH 2	Parcel Number	30-11A-17-024
Montville Lot 31	Sub lot	123	Fox Meadow	PH 2	Parcel Number	30-11A-17-025
Montville Lot 31	Sub lot	124	Fox Meadow	PH 2	Parcel Number	30-11A-17-026
Montville Lot 31	Sub lot	125	Fox Meadow	PH 2	Parcel Number	30-11A-17-027
Montville Lot 31	Sub lot	126	Fox Meadow	PH 2	Parcel Number	30-11A-17-028
Montville Lot 31	Sub lot	127	Fox Meadow	PH 2	Parcel Number	30-11A-16-003
Montville Lot 31	Sub lot	128	Fox Meadow	PH 2	Parcel Number	30-11A-16-004
Montville Lot 31	Sub lot	129	Fox Meadow	PH 2	Parcel Number	30-11A-16-004

25625-5

Located in Montville Township, Medina County, State of Ohio

Montville Lot 31	Sub lot	130	Fox Meadow	PH 2	Parcel Number	30-11A-16-005
Montville Lot 31	Sub lot	131	Fox Meadow	PH 2	Parcel Number	30-11A-16-006
Montville Lot 31	Sub lot	132	Fox Meadow	PH 2	Parcel Number	30-11A-16-007
Montville Lot 31	Sub lot	133	Fox Meadow	PH 2	Parcel Number	30-11A-17-029
Montville Lot 31	Sub lot	134	Fox Meadow	PH 2	Parcel Number	30-11A-17-030
Montville Lot 31	Sub lot	135	Fox Meadow	PH 2	Parcel Number	30-11A-17-031
Montville Lot 31	Sub lot	136	Fox Meadow	PH 2	Parcel Number	30-11A-17-032
Montville Lot 31	Sub lot	137	Fox Meadow	PH 2	Parcel Number	30-11A-17-033
Montville Lot 31	Sub lot	138	Fox Meadow	PH 2	Parcel Number	30-11A-17-034
Montville Lot 31	Sub lot	139	Fox Meadow	PH 2	Parcel Number	30-11A-17-035
Montville Lot 31	Sub lot	140	Fox Meadow	PH 2	Parcel Number	30-11A-17-036
Montville Lot 31	Sub lot	141	Fox Meadow	PH 2	Parcel Number	30-11A-17-037
Montville Lot 31	Sub lot	142	Fox Meadow	PH 2	Parcel Number	30-11A-17-038
Montville Lot 31	Sub lot	143	Fox Meadow	PH 2	Parcel Number	30-11A-17-039
Montville Lot 31	Sub lot	144	Fox Meadow	PH 2	Parcel Number	30-11A-17-040
Montville Lot 31	Sub lot	145	Fox Meadow	PH 2	Parcel Number	30-11A-17-041
Montville Lot 31	Sub lot	146	Fox Meadow	PH 2	Parcel Number	30-11A-16-008
Montville Lot 31	Sub lot	147	Fox Meadow	PH 2	Parcel Number	30-11A-16-009
Montville Lot 31	Sub lot	148	Fox Meadow	PH 2	Parcel Number	30-11A-16-010
Montville Lot 31	Sub lot	149	Fox Meadow	PH 2	Parcel Number	30-11A-16-011
Montville Lot 31	Sub lot	150	Fox Meadow	PH 2	Parcel Number	30-11A-16-012
Montville Lot 31	Sub lot	151	Fox Meadow	PH 2	Parcel Number	30-11A-16-013
Montville Lot 31	Sub lot	152	Fox Meadow	PH 2	Parcel Number	30-11A-16-014
Montville Lot 31	Sub lot	153	Fox Meadow	PH 2	Parcel Number	30-11A-16-015
Montville Lot 31	Sub lot	154	Fox Meadow	PH 2	Parcel Number	30-11A-17-042
Montville Lot 31	Sub lot	155	Fox Meadow	PH 2	Parcel Number	30-11A-17-043
Montville Lot 31	Sub lot	156	Fox Meadow	PH 2	Parcel Number	30-11A-17-044
Montville Lot 31	Sub lot	157	Fox Meadow	PH 2	Parcel Number	30-11A-17-045
Montville Lot 31	Sub lot	158	Fox Meadow	PH 2	Parcel Number	30-11A-17-046
Montville Lot 31	Sub lot	159	Fox Meadow	PH 2	Parcel Number	30-11A-17-047
Montville Lots 31, 42	Sub lot	160	Fox Meadow	PH 2	Parcel Number	30-11A-17-048
Montville Lots 31, 42	Sub lot	161	Fox Meadow	PH 2	Parcel Number	30-11A-17-049
Montville Lot 42	Sub lot	162	Fox Meadow	PH 2	Parcel Number	30-11A-17-050
Montville Lot 42	Sub lot	163	Fox Meadow	PH 2	Parcel Number	30-11A-17-051
Montville Lot 42	Sub lot	164	Fox Meadow	PH 2	Parcel Number	30-11A-17-052
Montville Lot 42	Sub lot	165	Fox Meadow	PH 2	Parcel Number	30-11A-17-053
Montville Lot 42	Sub lot	166	Fox Meadow	PH 2	Parcel Number	30-11A-17-054
Montville Lot 41	Sub lot	167	Fox Meadow	PH 3	Parcel Number	30-11A-21-016
Montville Lot 41	Sub lot	168	Fox Meadow	PH 3	Parcel Number	30-11A-21-017
Montville Lot 41	Sub lot	169	Fox Meadow	PH 3	Parcel Number	30-11A-21-019
Montville Lot 41	Sub lot	170	Fox Meadow	PH 3	Parcel Number	30-11A-21-020
Montville Lot 41	Sub lot	171	Fox Meadow	PH 3	Parcel Number	30-11A-21-021
Montville Lot 41	Sub lot	172	Fox Meadow	PH 3	Parcel Number	30-11A-21-022

256256

Located in Montville Township, Medina County, State of Ohio

Montville Lot 41	Sub lot	173	Fox Meadow	PH 3	Parcel Number	30-11A-21-023
Montville Lot 41	Sub lot	174	Fox Meadow	PH 3	Parcel Number	30-11A-21-024
Montville Lot 41	Sub lot	175	Fox Meadow	PH 3	Parcel Number	30-11A-22-154
Montville Lot 41	Sub lot	176	Fox Meadow	PH 3	Parcel Number	30-11A-22-156
Montville Lot 41	Sub lot	177	Fox Meadow	PH 3	Parcel Number	30-11A-22-157
Montville Lot 41	Sub lot	178	Fox Meadow	PH 3	Parcel Number	30-11A-22-158
Montville Lot 41	Sub lot	179	Fox Meadow	PH 3	Parcel Number	30-11A-22-159
Montville Lot 41	Sub lot	180	Fox Meadow	PH 3	Parcel Number	30-11A-22-160
Montville Lot 41	Sub lot	181	Fox Meadow	PH 3	Parcel Number	30-11A-21-025
Montville Lot 41	Sub lot	182	Fox Meadow	PH 3	Parcel Number	30-11A-21-027
Montville Lot 41	Sub lot	183	Fox Meadow	PH 3	Parcel Number	30-11A-21-028
Montville Lot 41	Sub lot	184	Fox Meadow	PH 3	Parcel Number	30-11A-22-161
Montville Lot 41	Sub lot	185	Fox Meadow	PH 3	Parcel Number	30-11A-22-162
Montville Lot 41	Sub lot	186	Fox Meadow	PH 3	Parcel Number	30-11A-22-162
Montville Lots 41,52	Sub lot	187A	Fox Meadow	PH 4	Parcel Number	30-11a-22-152
Montville Lots 41,52	Sub lot	189	Fox Meadow	PH 4	Parcel Number	30-11A-22-113
Montville Lots 41,52	Sub lot	190	Fox Meadow	PH 4	Parcel Number	30-11A-22-114
Montville Lots 41,52	Sub lot	191	Fox Meadow	PH 4	Parcel Number	30-11A-22-115
Montville Lots 41,52	Sub lot	192	Fox Meadow	PH 4	Parcel Number	30-11A-22-116
Montville Lots 41,52	Sub lot	193	Fox Meadow	PH 4	Parcel Number	30-11A-22-117
Montville Lot 52	Sub lot	194	Fox Meadow	PH 4	Parcel Number	30-11A-22-118
Montville Lot 52	Sub lot	195	Fox Meadow	PH 4	Parcel Number	30-11A-22-119
Montville Lot 52	Sub lot	196	Fox Meadow	PH 4	Parcel Number	30-11A-22-120
Montville Lot 52	Sub lot	197	Fox Meadow	PH 4	Parcel Number	30-11A-22-122
Montville Lot 52	Sub lot	198	Fox Meadow	PH 4	Parcel Number	30-11A-22-123
Montville Lot 52	Sub lot	199	Fox Meadow	PH 4	Parcel Number	30-11A-22-124
Montville Lot 52	Sub lot	200	Fox Meadow	PH 4	Parcel Number	30-11A-22-125
Montville Lot 41	Sub lot	201	Fox Meadow	PH 4	Parcel Number	30-11A-22-126
Montville Lot 41	Sub lot	202	Fox Meadow	PH 4	Parcel Number	30-11A-18-091
Montville Lot 41	Sub lot	203	Fox Meadow	PH 4	Parcel Number	30-11A-17-055
Montville Lot 41	Sub lot	204	Fox Meadow	PH 4	Parcel Number	30-11A-17-056
Montville Lot 41	Sub lot	205	Fox Meadow	PH 4	Parcel Number	30-11A-17-057
Montville Lot 41	Sub lot	206	Fox Meadow	PH 4	Parcel Number	30-11A-17-058
Montville Lot 41	Sub lot	207	Fox Meadow	PH 4	Parcel Number	30-11A-17-059
Montville Lot 41	Sub lot	208	Fox Meadow	PH 4	Parcel Number	30-11A-17-060
Montville Lot 41	Sub lot	209	Fox Meadow	PH 4	Parcel Number	30-11A-21-004
Montville Lot 41	Sub lot	210	Fox Meadow	PH 4	Parcel Number	30-11A-21-005
Montville Lot 41	Sub lot	211	Fox Meadow	PH 4	Parcel Number	30-11A-21-006
Montville Lot 41	Sub lot	212	Fox Meadow	PH 4	Parcel Number	30-11A-21-007
Montville Lot 41	Sub lot	213	Fox Meadow	PH 4	Parcel Number	30-11A-21-008
Montville Lot 41	Sub lot	214	Fox Meadow	PH 4	Parcel Number	30-11A-21-009
Montville Lot 41	Sub lot	215	Fox Meadow	PH 4	Parcel Number	30-11A-21-009
Montville Lot 41	Sub lot	216	Fox Meadow	PH 4	Parcel Number	30-11A-22-127

25625-7

Located in Montville Township, Medina County, State of Ohio

Montville Lot 41	Sub lot	217	Fox Meadow	PH 4		Parcel Number	30-11A-22-128
Montville Lot 41	Sub lot	218	Fox Meadow	PH 4		Parcel Number	30-11A-22-129
Montville Lot 41	Sub lot	219	Fox Meadow	PH 4		Parcel Number	30-11A-22-130
Montville Lot 41	Sub lot	220	Fox Meadow	PH 4		Parcel Number	30-11A-22-131
Montville Lot 41	Sub lot	221	Fox Meadow	PH 4		Parcel Number	30-11A-22-132
Montville Lot 41	Sub lot	222	Fox Meadow	PH 4		Parcel Number	30-11A-22-133
Montville Lot 41	Sub lot	223	Fox Meadow	PH 4		Parcel Number	30-11A-22-134
Montville Lot 41	Sub lot	224	Fox Meadow	PH 4		Parcel Number	30-11A-22-135
Montville Lot 41	Sub lot	225	Fox Meadow	PH 4		Parcel Number	30-11A-22-136
Montville Lot 41	Sub lot	226	Fox Meadow	PH 4		Parcel Number	30-11A-21-010
Montville Lot 41	Sub lot	227	Fox Meadow	PH 4		Parcel Number	30-11A-21-011
Montville Lot 41	Sub lot	228	Fox Meadow	PH 4		Parcel Number	30-11A-21-012
Montville Lot 41	Sub lot	229	Fox Meadow	PH 4		Parcel Number	30-11A-22-137
Montville Lot 41	Sub lot	230	Fox Meadow	PH 4		Parcel Number	30-11A-22-138
Montville Lot 41	Sub lot	231	Fox Meadow	PH 4		Parcel Number	30-11A-22-139
Montville Lot 41	Sub lot	232	Fox Meadow	PH 4		Parcel Number	30-11A-22-140
Montville Lot 41	Sub lot	233	Fox Meadow	PH 4		Parcel Number	30-11A-22-141
Montville Lot 41	Sub lot	234	Fox Meadow	PH 4		Parcel Number	30-11A-22-142
Montville Lot 41	Sub lot	235	Fox Meadow	PH 5		Parcel Number	30-11A-21-029
Montville Lot 41	Sub lot	236	Fox Meadow	PH 5		Parcel Number	30-11A-21-030
Montville Lot 41	Sub lot	237	Fox Meadow	PH 5		Parcel Number	30-11A-21-031
Montville Lot 41	Sub lot	238	Fox Meadow	PH 5		Parcel Number	30-11A-17-064
Montville Lot 41	Sub lot	239	Fox Meadow	PH 5		Parcel Number	30-11A-17-065
Montville Lot 41	Sub lot	240	Fox Meadow	PH 5		Parcel Number	30-11A-17-066
Montville Lots 41,42	Sub lot	241	Fox Meadow	PH 5		Parcel Number	30-11A-17-067
Montville Lots 41,42	Sub lot	242	Fox Meadow	PH 5		Parcel Number	30-11A-17-068
Montville Lot 42	Sub lot	243	Fox Meadow	PH 5		Parcel Number	30-11A-17-070
Montville Lot 42	Sub lot	244	Fox Meadow	PH 5		Parcel Number	30-11A-17-071
Montville Lot 42	Sub lot	245	Fox Meadow	PH 5		Parcel Number	30-11A-17-072
Montville Lot 42	Sub lot	246	Fox Meadow	PH 5		Parcel Number	30-11A-17-073
Montville Lots 31,42	Sub lot	247	Fox Meadow	PH 5		Parcel Number	30-11A-17-074
Montville Lot 31	Sub lot	248A	Fox Meadow	PH 5	Replate #2	Parcel Number	30-11A-17-075
Montville Lot 31	Sub lot	249	Fox Meadow	PH 5		Parcel Number	30-11A-17-076
Montville Lots 31,42	Sub lot	250	Fox Meadow	PH 5		Parcel Number	30-11A-17-078
Montville Lot 41	Sub lot	251	Fox Meadow	PH 5		Parcel Number	30-11A-17-079
Montville Lot 41	Sub lot	252	Fox Meadow	PH 5		Parcel Number	30-11A-17-080
Montville Lot 41	Sub lot	253	Fox Meadow	PH 5		Parcel Number	30-11A-17-081
Montville Lot 41	Sub lot	254	Fox Meadow	PH 5		Parcel Number	30-11A-17-082
Montville Lot 41	Sub lot	255	Fox Meadow	PH 5		Parcel Number	30-11A-17-083
Montville Lot 41	Sub lot	256	Fox Meadow	PH 5		Parcel Number	30-11A-21-035
Montville Lot 41	Sub lot	257	Fox Meadow	PH 5		Parcel Number	30-11A-21-036
Montville Lot 41	Sub lot	258	Fox Meadow	PH 5		Parcel Number	30-11A-21-037
Montville Lot 41	Sub lot	259	Fox Meadow	PH 5		Parcel Number	30-11A-21-038

25625-8

Located in Montville Township, Medina County, State of Ohio

Montville Lot 41	Sub lot	260	Fox Meadow	PH 5		Parcel Number	30-11A-21-039
Montville Lot 41	Sub lot	261	Fox Meadow	PH 5		Parcel Number	30-11A-21-040
Montville Lot 41	Sub lot	262	Fox Meadow	PH 5		Parcel Number	30-11A-21-041
Montville Lot 41	Sub lot	263	Fox Meadow	PH 5		Parcel Number	30-11A-21-042
Montville Lot 41	Sub lot	264	Fox Meadow	PH 5		Parcel Number	30-11A-21-043
Montville Lot 41	Sub lot	265	Fox Meadow	PH 5		Parcel Number	30-11A-21-044
Montville Lot 41	Sub lot	266	Fox Meadow	PH 5		Parcel Number	30-11A-21-045
Montville Lot 41	Sub lot	267	Fox Meadow	PH 5		Parcel Number	30-11A-21-046
Montville Lot 41	Sub lot	268	Fox Meadow	PH 5		Parcel Number	30-11A-21-047
Montville Lot 41	Sub lot	269	Fox Meadow	PH 5		Parcel Number	30-11A-21-048
Montville Lot 41	Sub lot	270	Fox Meadow	PH 5		Parcel Number	30-11A-21-049
Montville Lot 41	Sub lot	271	Fox Meadow	PH 5		Parcel Number	30-11A-21-051
Montville Lot 41	Sub lot	272	Fox Meadow	PH 5		Parcel Number	30-11A-21-052
Montville Lot 41	Sub lot	273	Fox Meadow	PH 5		Parcel Number	30-11A-21-053
Montville Lot 41	Sub lot	274	Fox Meadow	PH 5		Parcel Number	30-11A-21-054
Montville Lot 41	Sub lot	275	Fox Meadow	PH 5		Parcel Number	30-11A-21-071
Montville Lot 41	Sub lot	276	Fox Meadow	PH 5		Parcel Number	30-11A-21-070
Montville Lot 41	Sub lot	277	Fox Meadow	PH 5		Parcel Number	30-11A-21-069
Montville Lot 41	Sub lot	278	Fox Meadow	PH 5		Parcel Number	30-11A-21-068
Montville Lot 41	Sub lot	279	Fox Meadow	PH 5		Parcel Number	30-11A-21-067
Montville Lot 41	Sub lot	280	Fox Meadow	PH 5		Parcel Number	30-11A-21-066
Montville Lot 41	Sub lot	281	Fox Meadow	PH 5		Parcel Number	30-11A-21-065
Montville Lot 41	Sub lot	282	Fox Meadow	PH 5		Parcel Number	30-11A-21-064
Montville Lot 41	Sub lot	283	Fox Meadow	PH 5		Parcel Number	30-11A-21-063
Montville Lot 41	Sub lot	284	Fox Meadow	PH 5		Parcel Number	30-11A-21-062
Montville Lot 42	Sub lot	292	Fox Meadow	PH 6		Parcel Number	30-11A-12-111
Montville Lot 42	Sub lot	293	Fox Meadow	PH 6		Parcel Number	30-11A-12-112
Montville Lot 42	Sub lot	1	Hollows of Fox Meadow			Parcel Number	30-11A-12-041
Montville Lot 42	Sub lot	2	Hollows of Fox Meadow			Parcel Number	30-11A-12-042
Montville Lot 42	Sub lot	3	Hollows of Fox Meadow			Parcel Number	30-11A-12-043
Montville Lot 42	Sub lot	4	Hollows of Fox Meadow			Parcel Number	30-11A-12-044
Montville Lot 42	Sub lot	5	Hollows of Fox Meadow			Parcel Number	30-11A-13-018
Montville Lot 42	Sub lot	6	Hollows of Fox Meadow			Parcel Number	30-11A-13-019
Montville Lot 42	Sub lot	7	Hollows of Fox Meadow			Parcel Number	30-11A-13-020
Montville Lot 42	Sub lot	8	Hollows of Fox Meadow			Parcel Number	30-11A-12-045
Montville Lot 42	Sub lot	9	Hollows of Fox Meadow			Parcel Number	30-11A-12-046
Montville Lot 42	Sub lot	10A	Hollows of Fox Meadow			Parcel Number	30-11A-12-047
Montville Lot 42	Sub lot	11A	Hollows of Fox Meadow		(FKA SL 11)	Parcel Number	30-11A-12-048
Montville Lot 42	Sub lot	12	Hollows of Fox Meadow			Parcel Number	30-11A-12-049
Montville Lot 42	Sub lot	13	Hollows of Fox Meadow			Parcel Number	30-11A-12-050
Montville Lot 42	Sub lot	14	Hollows of Fox Meadow			Parcel Number	30-11A-12-051
Montville Lot 42	Sub lot	15	Hollows of Fox Meadow			Parcel Number	30-11A-12-052

25625-9

Located in Montville Township, Medina County, State of Ohio

Montville Lot 42	Sub lot	17A	Hollows of Fox Meadow		Parcel Number	30-11A-12-119
Montville Lot 42	Sub lot	18	Hollows of Fox Meadow		Parcel Number	30-11A-12-055
Montville Lot 42	Sub lot	D3	Hollows of Fox Meadow		Parcel Number	30-11A-12-116
Montville Lot 42	Sub lot	20A	Hollows of Fox Meadow		Parcel Number	30-11A-12-106
Montville Lot 42	Sub lot		Hollows of Fox Meadow		Parcel Number	
Montville Lot 42	Sub lot	22	Hollows of Fox Meadow		Parcel Number	30-11A-12-059
Montville Lot 42	Sub lot	23	Hollows of Fox Meadow		Parcel Number	30-11A-12-060
Montville Lot 42	Sub lot	24	Hollows of Fox Meadow		Parcel Number	30-11A-12-061
Montville Lot 42	Sub lot	25	Hollows of Fox Meadow		Parcel Number	30-11A-12-062
Montville Lot 42	Sub lot	26	Hollows of Fox Meadow		Parcel Number	30-11A-12-063
Montville Lot 42	Sub lot	27	Hollows of Fox Meadow		Parcel Number	30-11A-12-064
Montville Lot 42	Sub lot	28	Hollows of Fox Meadow		Parcel Number	30-11A-12-065
Montville Lot 42	Sub lot	29	Hollows of Fox Meadow		Parcel Number	30-11A-12-066
Montville Lot 42	Sub lot	30	Hollows of Fox Meadow		Parcel Number	30-11A-12-067
Montville Lot 42	Sub lot	31	Hollows of Fox Meadow		Parcel Number	30-11A-12-068
Montville Lot 42	Sub lot	32	Hollows of Fox Meadow		Parcel Number	30-11A-12-069
Montville Lot 42	Sub lot	33	Hollows of Fox Meadow		Parcel Number	30-11A-12-070
Montville Lot 42	Sub lot	34	Hollows of Fox Meadow		Parcel Number	30-11A-12-071
Montville Lot 42	Sub lot	35	Hollows of Fox Meadow		Parcel Number	30-11A-12-072
Montville Lot 52	Sub lot	1	Country Lakes Cluster Home Community at Fox Meadow	PH 1	Parcel Number	30-11A-22-014
Montville Lot 52	Sub lot	2	Country Lakes Cluster Home Community at Fox Meadow	PH 1	Parcel Number	30-11A-22-015
Montville Lot 52	Sub lot	3	Country Lakes Cluster Home Community at Fox Meadow	PH 1	Parcel Number	30-11A-22-016
Montville Lot 52	Sub lot	4	Country Lakes Cluster Home Community at Fox Meadow	PH 1	Parcel Number	30-11A-22-017
Montville Lot 52	Sub lot	5	Country Lakes Cluster Home Community at Fox Meadow	PH 1	Parcel Number	30-11A-22-018
Montville Lot 52	Sub lot	6	Country Lakes Cluster Home Community at Fox Meadow	PH 1	Parcel Number	30-11A-22-019
Montville Lot 52	Sub lot	7	Country Lakes Cluster Home Community at Fox Meadow	PH 1	Parcel Number	30-11A-22-020
Montville Lot 52	Sub lot	8	Country Lakes Cluster Home Community at Fox Meadow	PH 1	Parcel Number	30-11A-22-021
Montville Lot 52	Sub lot	9	Country Lakes Cluster Home Community at Fox Meadow	PH 1	Parcel Number	30-11A-22-022
Montville Lot 52	Sub lot	10	Country Lakes Cluster Home Community at Fox Meadow	PH 1	Parcel Number	30-11A-22-023
Montville Lot 52	Sub lot	11	Country Lakes Cluster Home Community at Fox Meadow	PH 1	Parcel Number	30-11A-22-024
Montville Lot 52	Sub lot	12	Country Lakes Cluster Home Community at Fox Meadow	PH 2	Parcel Number	30-11A-22-025
Montville Lot 52	Sub lot	13A	Country Lakes Cluster Home Community at Fox Meadow	PH 2	Parcel Number	30-11A-22-107
Montville Lot 52	Sub lot	14A	Country Lakes Cluster Home Community at Fox Meadow	PH 2	Parcel Number	30-11A-22-108
Montville Lot 52	Sub lot	15A	Country Lakes Cluster Home Community at Fox Meadow	PH 2	Parcel Number	30-11A-22-109
Montville Lot 52	Sub lot	16A	Country Lakes Cluster Home Community at Fox Meadow	PH 1 & 2	Parcel Number	30-11A-22-153
Montville Lot 52	Sub lot	17	Country Lakes Cluster Home Community at Fox Meadow	PH 1	Parcel Number	30-11A-22-031
Montville Lot 52	Sub lot	18	Country Lakes Cluster Home Community at Fox Meadow	PH 1	Parcel Number	30-11A-22-032
Montville Lot 52	Sub lot	19	Country Lakes Cluster Home Community at Fox Meadow	PH 1	Parcel Number	30-11A-22-033
Montville Lot 52	Sub lot	20	Country Lakes Cluster Home Community at Fox Meadow	PH 1	Parcel Number	30-11A-22-034
Montville Lot 52	Sub lot	21	Country Lakes Cluster Home Community at Fox Meadow	PH 1	Parcel Number	30-11A-22-035
Montville Lot 52	Sub lot	22	Country Lakes Cluster Home Community at Fox Meadow	PH 1	Parcel Number	30-11A-22-036
Montville Lot 52	Sub lot	23	Country Lakes Cluster Home Community at Fox Meadow	PH 1	Parcel Number	30-11A-22-037

25625-10

Located in Montville Township, Medina County, State of Ohio

Montville Lot 52	Sub lot	112	Country Lakes Cluster Home Community at Fox Meadow	PH 3	PH 3	Parcel Number	30-11A-22-190
Montville Lot 52	Sub lot	113	Country Lakes Cluster Home Community at Fox Meadow	PH 3	PH 3	Parcel Number	30-11A-22-191
Montville Lot 52	Sub lot	114	Country Lakes Cluster Home Community at Fox Meadow	PH 3	PH 3	Parcel Number	30-11A-22-192
Montville Lot 52	Sub lot	115	Country Lakes Cluster Home Community at Fox Meadow	PH 3	PH 3	Parcel Number	30-11A-22-193
Montville Lot 52	Sub lot	116	Country Lakes Cluster Home Community at Fox Meadow	PH 3	PH 3	Parcel Number	30-11A-22-194
Montville Lot 52	Sub lot	117	Country Lakes Cluster Home Community at Fox Meadow	PH 3	PH 3	Parcel Number	30-11A-22-195
Montville Lot 52	Sub lot	118	Country Lakes Cluster Home Community at Fox Meadow	PH 3	PH 3	Parcel Number	30-11A-22-196
Montville Lot 52	Sub lot	119	Country Lakes Cluster Home Community at Fox Meadow	PH 3	PH 3	Parcel Number	30-11A-22-197
Montville Lot 52	Sub lot	120	Country Lakes Cluster Home Community at Fox Meadow	PH 3	PH 3	Parcel Number	30-11A-22-198
Montville Lot 52	Sub lot	121	Country Lakes Cluster Home Community at Fox Meadow	PH 3	PH 3	Parcel Number	30-11A-22-199
Montville Lot 52	Sub lot	122	Country Lakes Cluster Home Community at Fox Meadow	PH 3	PH 3	Parcel Number	30-11A-22-200
Montville Lot 52				PH 2		Parcel Number	30-11A-27-007
Montville Lot 52.61				PH 2		Parcel Number	30-11A-22-009
Montville Lot 52				PH 2		Parcel Number	30-11A-27-008
Montville Lot 52				PH 4		Parcel Number	30-11A-22-150
Montville Lot 52				PH 4		Parcel Number	30-11A-22-145
Montville Lot 41.52				PH 4		Parcel Number	30-11A-22-144
Montville Lot 41.52				PH 4		Parcel Number	30-11A-22-143
Montville Lot 41				PH 4		Parcel Number	30-11A-21-013
Montville Lot 41				PH 4		Parcel Number	30-11A-18-090
Montville Lot 41				PH 1A		Parcel Number	30-11A-21-001
Montville Lot 42.51.52				PH 1A		Parcel Number	30-11A-18-086
Montville Lot 41				PH 1		Parcel Number	30-11A-18-089
Montville Lot 41.42.51.52				PH 1A		Parcel Number	30-11A-17-010
Montville Lot 41.42.52				PH 2		Parcel Number	30-11A-18-085
Montville Lot 41				PH 1		Parcel Number	30-11A-17-007
Montville Lot 42.51				PH 2		Parcel Number	30-11A-17-009
Montville Lot 42				PH 2		Parcel Number	30-11A-17-003
Montville Lot 42				PH 2		Parcel Number	30-11A-17-006
Montville Lot 31				PH 1A		Parcel Number	30-11A-13-017
Montville Lot 31				PH 2		Parcel Number	30-11A-16-002
Montville Lot 42				PH 2		Parcel Number	30-11A-12-079
Montville Lot 41.42				PH 2		Parcel Number	30-11A-12-080
Montville Lot 42				PH 1		Parcel Number	30-11A-17-009
Montville Lot 42				PH 2		Parcel Number	30-11A-12-076
Montville Lot 31				PH 2		Parcel Number	30-11A-12-077
Montville Lot 42				PH 2		Parcel Number	30-11A-12-074
Montville Lot 42				PH 2		Parcel Number	30-11A-12-113
Montville Lot 41.52				PH 2		Parcel Number	30-11A-22-010
Montville Lot 42				PH 2		Parcel Number	30-11A-12-113
Montville Lot 42				PH 6		Parcel Number	30-11A-12-075
Montville Lot 42				PH 2		Parcel Number	30-11A-21-034
Montville Lot 41				PH 5		Parcel Number	30-11A-17-077
Montville Lot 31.41.42				PH 5		Parcel Number	30-11A-21-033
Montville Lot 41				PH 5		Parcel Number	30-11A-21-050
Montville Lot 41				PH 5		Parcel Number	30-11A-21-050

25625-13

Montville Lot 42	BLK-VVV											Parcel Number
Montville Lot 41	BLK-BBB											30-11A-17-069
Montville Lot 41	BLK-GG											30-11A-17-063
Montville Lot 41	BLK-XX											30-11A-26-009
Montville Lot 41	BLK-HH											30-11A-21-032
Montville Lot 41	BLK-HH											30-11A-22-155
Montville Lot 41	BLK-FE											30-11A-21-018

99 Lot 42	BLK-D1	Hollows of Fox Meadow	030-11A-12-040
99 Lot 42	BLK-D2	Hollows of Fox Meadow	030-11A-12-043
99 Lot 42, 51	BLK-E	Fox Meadow Ph 1A	030-11A-18-087
99 Lot 31, 41, 42, 51, 52, 61	BLK-F	Fox Meadow Ph 1A	030-11A-18-088
99 Lot 42	BLK-L	Fox Meadow Ph-1A	030-11A-17-005
99 Lot 31, 42	BLK-U	Fox Meadow Ph-2	030-11A-17-008
99 Lot 41	BLK-AA	Fox Meadow Ph-3	030-11A-27-009
99 Lot 41, 42	BLK-BB	Fox Meadow Ph 2	030-11A-21-002
99 Lot 41	BLK-CC	Fox Meadow Ph 2	030-11A-21-003

Montville Lot 41	BLK-JT	Fox Meadow Ph 4	030-11A-17-061
Montville Lot 41	BLK-KK	Fox Meadow Ph 4	030-11A-17-062
Montville Lot 41	BLK-LL	Fox Meadow Ph 4	030-11A-18-092
Montville Lot 52	BLK-PP	Fox Meadow Ph 4	030-11A-22-146
Montville Lot 52	BLK-QQ	Fox Meadow Ph 4	030-11A-22-147
Montville Lot 52	BLK-RR	Fox Meadow Ph 4	030-11A-22-148
Montville Lot 41, 52	BLK-SS	Fox Meadow Ph 4	030-11A-22-149
Montville Lot 41	BLK-UU	Fox Meadow Ph 4	030-11A-22-151
Montville Lot 41	Sublot 285	Fox Meadow Ph 5	030-11A-21-061
Montville Lot 41	Sublot 286	Fox Meadow Ph 5	030-11A-21-060
Montville Lot 41	Sublot 287	Fox Meadow Ph 5	030-11A-21-059
Montville Lot 41	Sublot 288	Fox Meadow Ph 5	030-11A-21-058
Montville Lot 41	Sublot 289	Fox Meadow Ph 5	030-11A-21-057
Montville Lot 41	Sublot 290	Fox Meadow Ph 5	030-11A-21-056
Montville Lot 41	Sublot 291	Fox Meadow Ph 5	030-11A-21-055

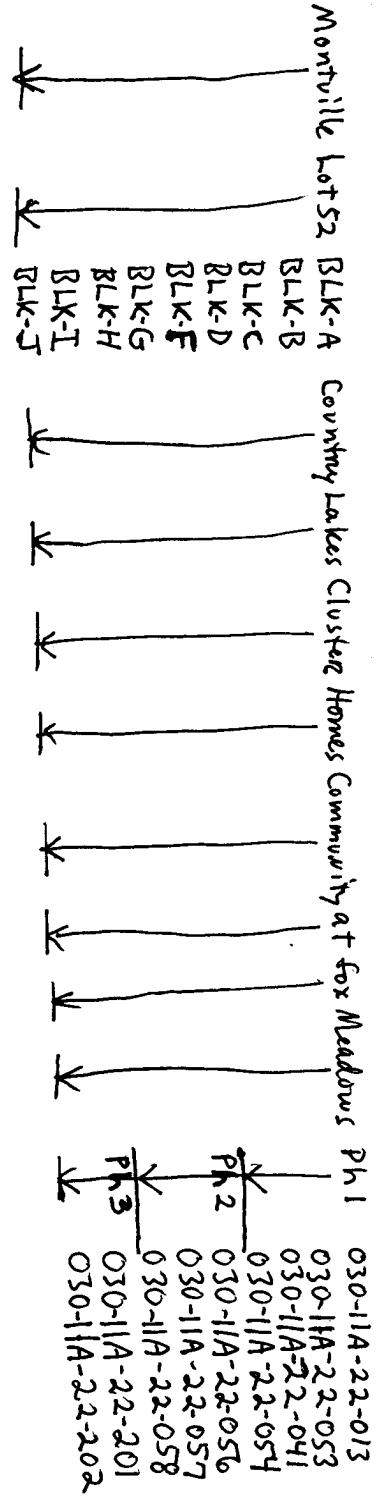

25625-14